

# Christian County, KY PVA

## Summary

**Parcel Number** 137-00-00-070.00  
**Account Number** 65058  
**Location Address** 5510 ANTIOCH CHURCH RD  
**Description** 5510 ANTIOCH CHURCH RD  
(Note: Not to be used on legal documents)  
**Class** FARM (20)  
**Tax District** 00-County  
**Deed Book/Page** 428-155

[View Map](#)



## Tax Rates

[See Tax Rates](#)

## Owner

NASH BARBARA A  
 4160 HARGROVE MARABLE RD  
 PALMYRA, TN 37142

## Valuation

Assessed Year	2025	2024
	Working Tax Roll	Certified Tax Roll
Total Assessed Value		
Farm Fair Cash Value	\$290,750.00	\$290,750.00
Farm Taxable Value	\$80,030.00	\$80,030.00

## Sales Information

Sale Date	Sale Price	Deed Book	Deed Page	Grantee	Grantor
1/1/1981	\$0	428	155	NASH BARBARA A	

## Land Information

Condition	None	Topography	Not Used
Plat Book/Page		Drainage	None
Subdivision		Flood Hazard	
Lot		Zoning	Residential
Block		Electric	No
Acres	34.00	Water	No
Front	0	Gas	No
Depth	0	Sewer	No
Lot Size	0x0	Road	2 Lane
Lot Sq Ft	1481040	Sidewalks	No
Shape	None	Information Source	

## Improvement Information

Description	HOUSE Single Family NASH BARBARA A	Heat	Electric
Type	Single Family	AC	
Year Built	0	Living Sqft	1002
Foundation	Concrete Block	Basement Sqft	0
Basement	BT-None, None	Garage Sqft	0
Exterior	Masonite	Porch Sqft	0
Bedrooms	2	Patio Sqft	0
Full Baths	1	Basement Finish	BT-None, None
Half Baths	0	Structure	
Roof Cover	RF-Metal	Garage	
Condition	None		
Fireplace	False		

## Photos



Sketches

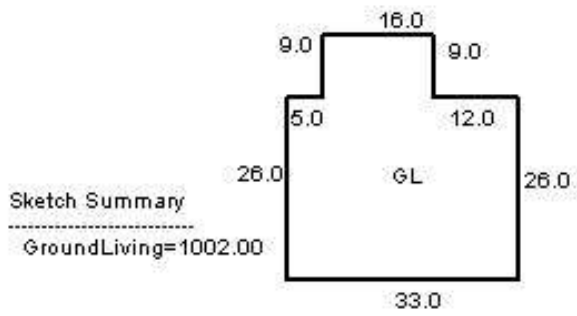

Scale: 1 inch = 30.0

No data available for the following modules: Commercial Improvements.

The Christian County Assessor's Office makes every effort to produce the most accurate information possible. No warranties, expressed or implied, are provided for the data herein, its use or interpretation.  
[User Privacy Policy](#) | [GDPR Privacy Notice](#)  
Last Data Upload: 10/16/2024, 2:25:43 PM

Contact Us

Developed by  
 SCHNEIDER  
GEO SPATIAL