

Soils Map

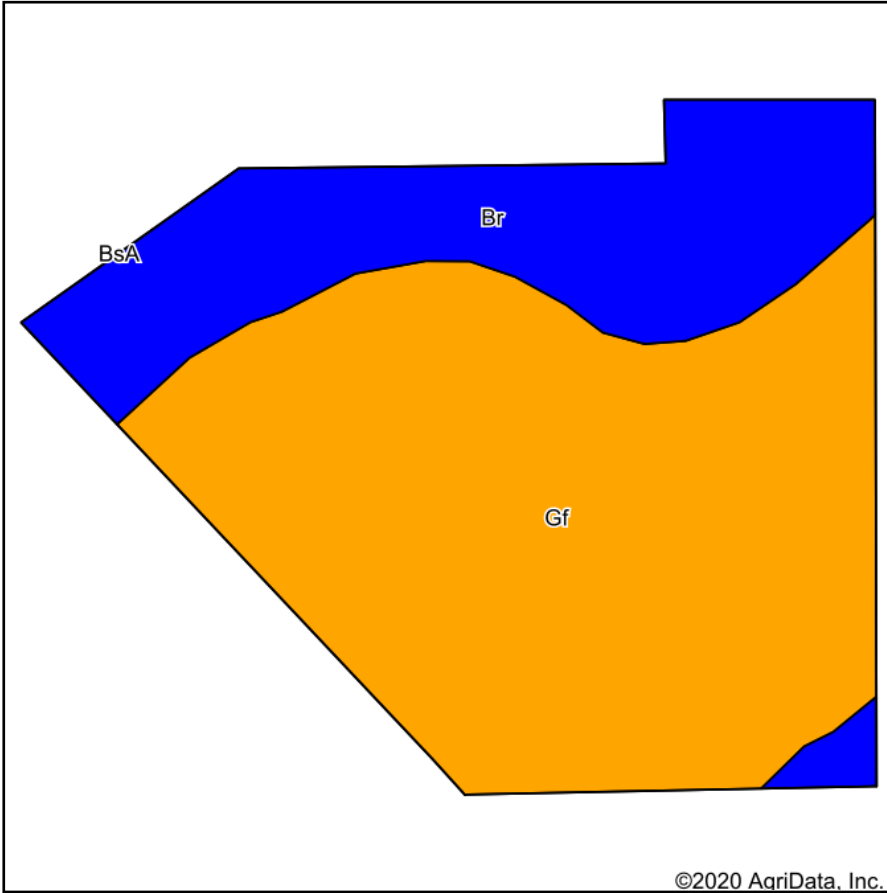

Soils data provided by USDA and NRCS.

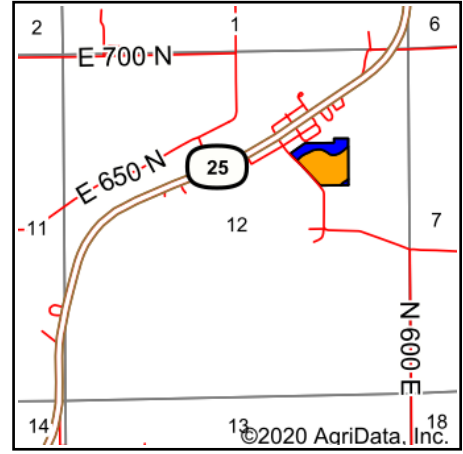

State: **Indiana**
 County: **Fulton**
 Location: **12-31N-3E**
 Township: **Newcastle**
 Acres: **10.64**
 Date: **9/15/2020**



Area Symbol: IN049, Soil Area Version: 23								
Code	Soil Description	Acres	Percent of field	Non-Irr Class Legend	Non-Irr Class *c	Corn	Soybeans	*n NCCPI Soybeans
Gf	Gilford fine sandy loam, 0 to 2 percent slopes, gravelly subsoil	7.44	69.9%		IIIw	150	42	54
Br	Brady sandy loam	3.20	30.1%		IIw	124	35	51
Weighted Average						142.2	39.9	*n 53.1

*n: The aggregation method is "Weighted Average using all components"

*c: Using Capabilities Class Dominant Condition Aggregation Method

Soils data provided by USDA and NRCS.