

Soils Map

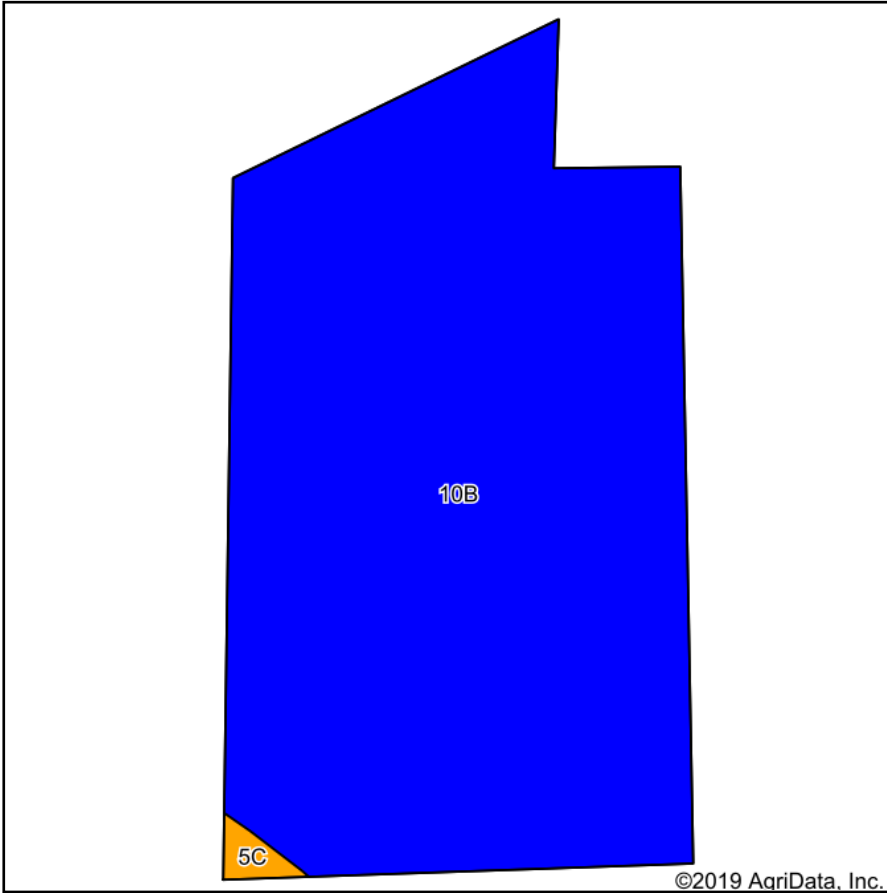

Soils data provided by USDA and NRCS.

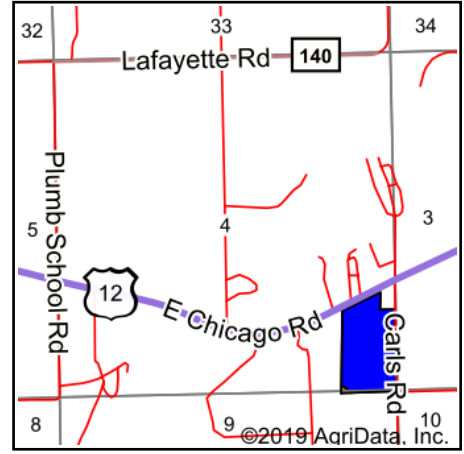

State: **Michigan**
 County: **St Joseph**
 Location: **4-8S-9W**
 Township: **Fawn River**
 Acres: **26.94**
 Date: **7/23/2019**



Area Symbol: MI149. Soil Area Version: 11

Code	Soil Description	Acres	Percent of field	Non-Irr Class Legend	Non-Irr Class *c	Irr Class *c	Corn	Soybeans	*n NCCPI Soybeans
10B	Hillsdale sandy loam, 2 to 6 percent slopes	26.71	99.1%		Ile	Ile	100	35	56
5C	Spinks loamy sand, 6 to 12 percent slopes	0.23	0.9%		IIle	IIle			29
Weighted Average							99.1	34.7	*n 55.8

*n: The aggregation method is "Weighted Average using major components"

*c: Using Capabilities Class Dominant Condition Aggregation Method

Soils data provided by USDA and NRCS.