

Tazewell County

Search Locality

VamaNet

Virginia Mass Appraisal Network

[-Home-](#) [-Legal-](#) [-Contact VamaNet-](#) [-Commissioners-](#) [-Localities-](#) [-FAQs-](#) [-About this Site-](#)

Property Information - Tax Map# 024A2A 0059 - Account# 18832

Property Owner:
Thistle Foundry & Machine

Owners Address:
101 Thistle St
Bluefield, Va 24605

Total Land Area:
0.800Acres

Physical Location:
108 Thistle St

Magisterial District:
Town Of Bluefield

Legal Description:
Lot, Town Of Bluefield
Mill Property

Prior Assessment: 340,100

Assessment Values:
[Building 1](#) 268,426

[Other Improvements:](#) 0

[Land Value:](#) 25,000

Calculated Value: 293,426

Rounded Taxable Value: 293,400



[View Pictures](#)
(Building 1)

[View Sketch](#)
(Building 1)

[-Property Information-](#) [-Sales Information-](#)

If you encounter any difficulties with this site, please e-mail the [Webmaster](#).
All rights reserved, Copyright© 2020

Tazewell County

Search Locality

VamaNet

Virginia Mass Appraisal Network

[-Home-](#) [-Legal-](#) [-Contact VamaNet-](#) [-Commissioners-](#) [-Localities-](#) [-FAQs-](#) [-About this Site-](#)

Building Information - Building #1 - Tax Map# 024A2A 0059

Exterior Information:

Year Built: 1985
 Occupancy Type: Commercial
 Foundation: Slab
 Ext. Walls: Metal
 Roofing: Metal
 Roof Type: Gable
 Garage: None
 Carport: None

Interior Information:

Story Height: 1.00
 # of Rooms: 1
 # of Bedrooms: Not On File
 Full Bathrooms: None
 Half Bathrooms: 1
 Building Sq. Ft.: 17404
 Basement Sq.Ft.: None
 Fin. Bsmt Sq. Ft.: None
 Interior Walls: Metal
 Floors: Concrete
 Heating: Unit Heater
 A/C: No

Site Information:

Terrain Type: On
 Character: Rolling/sloping
 Right of Way: Public
 Easements: Paved
 Water: None
 Sewer: None
 Electric: Yes
 Gas: No
 Fuel Type: Gas
 Fireplace: None
 Stacked Fireplace: None
 Flues: None
 Metal Flues: None
 Stacked Flues: None
 Inop Flue/FP: None
 Gas Log FP: None

[-Property Information-](#) [-Sales Information-](#) [-View Pictures-](#) [-View Sketch-](#)

If you encounter any difficulties with this site, please e-mail the [Webmaster](#).
 All rights reserved, Copyright© 2020

Tazewell County

Search Locality

VamaNet

Virginia Mass Appraisal Network

[-Home-](#) [-Legal-](#) [-Contact VamaNet-](#) [-Commissioners-](#) [-Localities-](#) [-FAQs-](#) [-About this Site-](#)

Sketch Index
Map No. 024A2A 0059
Building 1

Sect	Type	Stories	SqFt
A	Industrial-metal	1.00	16036
B	Industrial-cb/fr	1.00	576
C	Canopy	1.00	792

This Sketch only represents the Exterior of the Structure and does not contain any Internal structural details.

Click the image for actual size view.

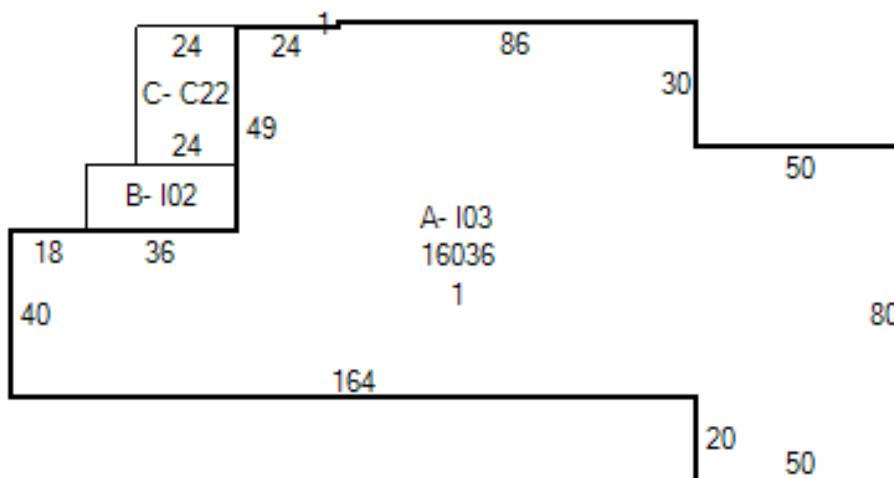

[-Property Information-](#) [-Sales Information-](#) [-View Pictures-](#)

If you encounter any difficulties with this site, please e-mail the [Webmaster](#).
All rights reserved, Copyright© 2020

Tazewell County

VamaNet

Virginia Mass Appraisal Network

Search Locality

[-Home-](#) [-Legal-](#) [-Contact VamaNet-](#) [-Commissioners-](#) [-Localities-](#) [-FAQs-](#) [-About this Site-](#)

Sales Information - Tax Map# 024A2A 0059

Name	Sales Date	Sales Price	Instrument	Grantor
Thistle Foundry & Machine	6/28/1996	\$12,000	Deed: 713 / 942	Farquharson, John Cameron(wb26-158)

[-Property Information-](#) [-Sales Information-](#)

If you encounter any difficulties with this site, please e-mail the [Webmaster](#).
All rights reserved, Copyright© 2020