

Tazewell County

Search Locality

VamaNet

Virginia Mass Appraisal Network

[-Home-](#) [-Legal-](#) [-Contact VamaNet-](#) [-Commissioners-](#) [-Localities-](#) [-FAQs-](#) [-About this Site-](#)

Property Information - Tax Map# 024A2A 0057 - Account# 18834

Property Owner:
Thistle Foundry & Machine

Owners Address:
101 Thistle St
Bluefield, Va 24605

Total Land Area:
Not on File

Physical Location:
101 Thistle St

Magisterial District:
Town Of Bluefield

Legal Description:
Parcel
Town Of Bluefield

Prior Assessment: 129,700

Assessment Values:

[Building 1](#) 123,900

[Other Improvements:](#) 0

[Land Value:](#) 20,000

Total Value: 143,900

All Values Rounded to nearest 100



[View Pictures](#)
(Building 1)

[View Sketch](#)
(Building 1)

[-Property Information-](#) [-Sales Information-](#)

If you encounter any difficulties with this site, please e-mail the [Webmaster](#).
All rights reserved, Copyright© 2020

Tazewell County

Search Locality

VamaNet

Virginia Mass Appraisal Network

[-Home-](#) [-Legal-](#) [-Contact VamaNet-](#) [-Commissioners-](#) [-Localities-](#) [-FAQs-](#) [-About this Site-](#)

Building Information - Building #1 - Tax Map# 024A2A 0057**Exterior Information:**

Year Built: 1930
Occupancy Type: Commercial
Foundation: Concrete
Ext. Walls: Metal
Brick
Roofing: Metal
Roof Type: Gable
Garage: None
Carport: None

Interior Information:

Story Height: 1.00
of Rooms: Not On File
of Bedrooms: Not On File
Full Bathrooms: None
Half Bathrooms: 3
Building Sq. Ft.: 7399
Basement Sq.Ft.: None
Fin. Bsmt Sq. Ft.: None
Interior Walls: Drywall
Unfinished
Floors: Tile
Concrete
Heating: Ht. Pump
A/C: Yes

Site Information:

Terrain Type: On
Character: Rolling/sloping
Right of Way: Public
Easements: Paved
Water: Pub-i
Sewer: Pub-i
Electric: Yes
Gas: Yes
Fuel Type: Electric
Fireplace: None
Stacked Fireplace: None
Flues: None
Metal Flues: None
Stacked Flues: None
Inop Flue/FP: None
Gas Log FP: None

[-Property Information-](#) [-Sales Information-](#) [-View Pictures-](#) [-View Sketch-](#)

If you encounter any difficulties with this site, please e-mail the [Webmaster](#).
All rights reserved, Copyright© 2020

Tazewell County

VamaNet

Virginia Mass Appraisal Network

Search Locality

[-Home-](#) [-Legal-](#) [-Contact VamaNet-](#) [-Commissioners-](#) [-Localities-](#) [-FAQs-](#) [-About this Site-](#)

Sketch Index
Map No. 024A2A 0057
Building 1

Sect	Type	Stories	SqFt
A	Industrial-brick	1.00	3399
B	Industrial-metal	1.00	3040
C	Off Bldg-metal	1.00	960

This Sketch only represents the Exterior of the Structure and does not contain any Internal structural details.

Click the image for actual size view.

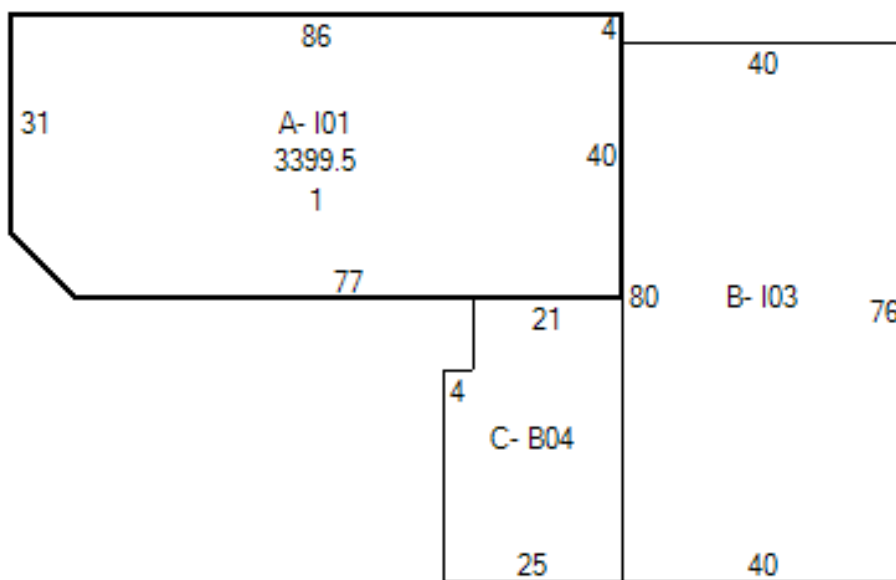

[-Property Information-](#) [-Sales Information-](#) [-View Pictures-](#)

If you encounter any difficulties with this site, please e-mail the [Webmaster](#).
All rights reserved, Copyright© 2020

Tazewell County

Search Locality

VamaNet

Virginia Mass Appraisal Network

[-Home-](#) [-Legal-](#) [-Contact VamaNet-](#) [-Commissioners-](#) [-Localities-](#) [-FAQs-](#) [-About this Site-](#)

Sales Information - Tax Map# 024A2A 0057

Name	Sales Date	Sales Price	Instrument	Grantor
Thistle Foundry & Machine	6/28/1996	\$12,000	Deed: 713 / 942	Farquharson, John Cameron(wb26-158)

[-Property Information-](#) [-Sales Information-](#)

If you encounter any difficulties with this site, please e-mail the [Webmaster](#).
All rights reserved, Copyright© 2020