

FARMLAND AUCTION

**19 +/-
ACRES**

Property Address: 22444 Walbridge Rd, Curtice OH 43412

Located between N. Genoa Clay Center Rd. & N. Reiman Rd.

Wednesday February 27th, 2019 at 11:00 am

Auction Held at Millbury Fireman's Rec Hall

28410 Oak St, Millbury, OH 43447

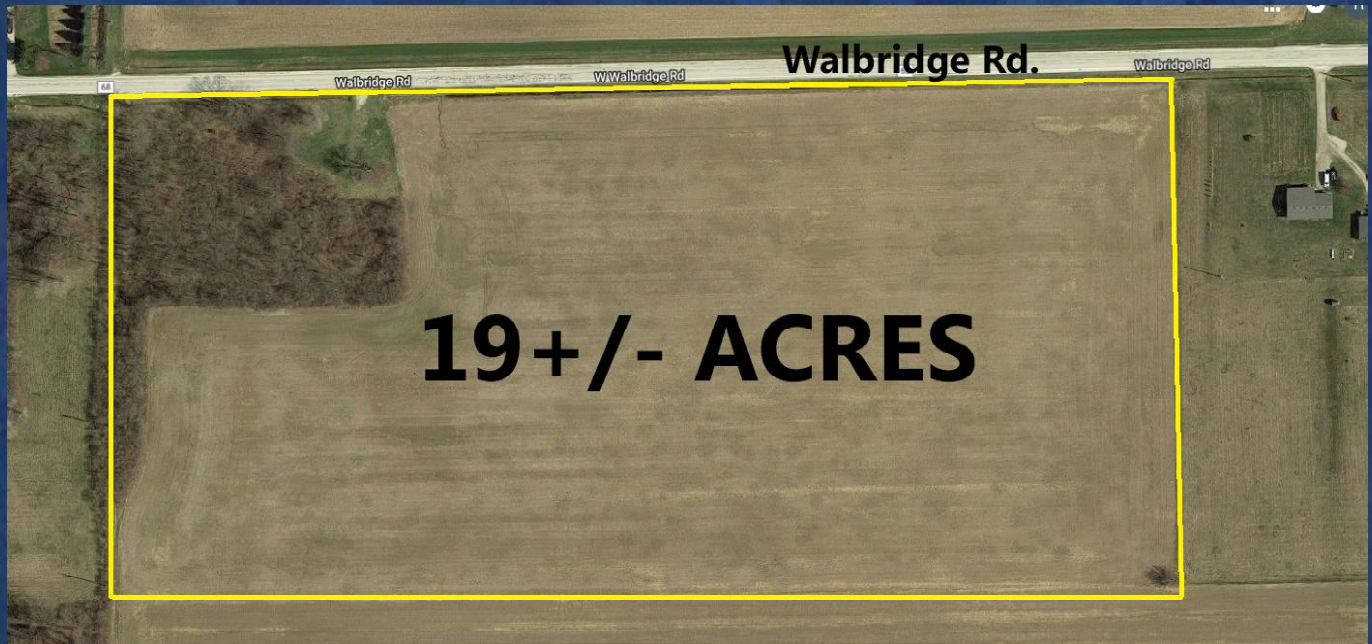

19+/- Acres selling as 1 Unit! Great hobby size farm or estate building site that is centrally located to Genoa & Curtice. Allen Twp, Ottawa County, Genoa Schools.

Tax Parcel: 0010036200417000

Township: Allen Twp

County: Ottawa

Taxes: \$540.34 per year

Parcel Size: 19 +/- Acres

Approx 1245' frontage x 664'

Mostly Tillable 18.4 acres, 0.6 acres in RoW

Soils: Nappanee silty clay loam 10.87 acres

Hoytville silty clay loam 7.53 acres

Schools: Genoa Area S. D.

**Owner
John Vargo**

Terms: \$7,000.00 down the day of auction in certified funds with balance at closing. Closing held on or before 45 days. Possession upon receipt of down payment for farming purposes. Have finances ready, selling with immediate confirmation. No Buyer's Premium. All information was derived from sources believed to be correct but not guaranteed. Dimensions are approximate. Buyers need to rely entirely on their own judgment and inspection of property records. Any other terms & conditions will be announced the day of the auction and take precedence over printed material.

WHALEN 
REALTY & AUCTION, LTD.

whalenauction.com
Twitter @WhalenAuction

Auctioneers
John & Jason Whalen, Mike Murry
419-875-6317, 419-337-7653
info@whalenauction.com