

Agent 360

1185 Dager Rd, Warminster, PA 18974-1910

Warminster Twp

Tax ID 49-037-047

Public Records

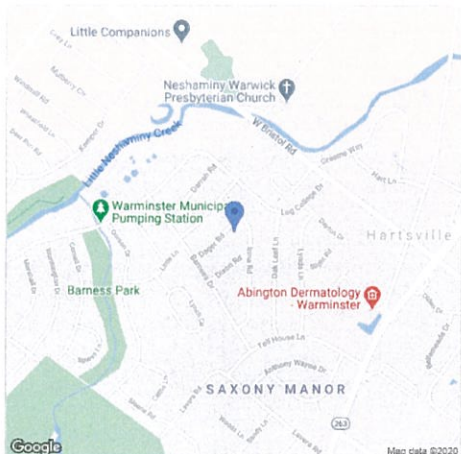

Summary Information

Owner:	Samuel T & Edith Foster	Property Class:	Residential
Owner Address:	1185 Dager Rd	Annual Tax:	\$4,849
Owner City State:	WARMINSTER PA	Record Date:	02/09/62
Owner Zip+4:	18974-1910	Settle Date:	02/09/62
Owner Occupied:	Yes	Book:	1640
No Mail(P):	No	Page:	98
Owner Carrier Rt:	C013	Tax Record Updated:	09/03/19

Geographic Information

County:	Bucks, PA	Lot:	047
Municipality:	Warminster Twp	Grid:	7598A7
High Sch Dist:	Centennial	Census:	1016.102
Subdiv/Neighbrhd:	Hartsville Park		
Tax ID:	49-037-047		
Tax Map:	037		

Assessment & Tax Information

Tax Year:	2020	Annual Tax:	\$4,849	Total Land Asmt:	\$4,800
County Tax:	\$631	Taxable Land Asmt:	\$4,800	Total Bldg Asmt:	\$20,000
Municipal Tax:	\$572	Taxable Bldg Asmt:	\$20,000	Total Asmt:	\$24,800
School Tax:	\$3,646			Taxable Total Asmt:	\$24,800

Lot Characteristics

Frontage:	86.00	Sq Ft:	9,030	Zoning:	R2
Depth:	105.00	Acres:	0.2073		

Building Characteristics

Total SQFT:	1,317	Total Rooms:	6	Basement Type:	Partial
Bldg Footprint SQFT:	1,107	Bed Rooms:	3	Gas:	Public
Residential Type:	Single/Det	Full Baths:	2	Water:	Public
Residential Design:	Split/Multi-Level	Total Baths:	2.0	Sewer:	Public
Stories:	1.00	Family Room:	0	Year Built:	1961
Total Units:	1	Total Fixtures:	8		
Abv Grd Fin SQFT:	1,317	Exterior:	Frame		
Fireplace Total:	0				

Codes & Descriptions

Land Use: 1005 Res: Split Level
 County Legal Desc: HARTSVILLE PARK SEC C;LOT#254;86X105

MLS History

Tax History

Year	County	Annual Tax Amounts		
		Municipal	School	Annual
2020	\$631	\$572	\$3,646	\$4,849
2019	\$606	\$423	\$3,578	\$4,608
2018	\$606	\$423	\$3,498	\$4,527
2017	\$575	\$423	\$3,389	\$4,388
2016	\$575	\$423	\$3,291	\$4,289
2015	\$575	\$423	\$3,144	\$4,142
2014	\$575	\$423	\$3,030	\$4,029
2013	\$575	\$423	\$2,927	\$3,926
2012	\$575	\$423	\$2,879	\$3,877
2011	\$544	\$423	\$2,817	\$3,784
2010	\$544	\$299	\$2,692	\$3,535
2009	\$544	\$299	\$2,547	\$3,390
2008	\$544	\$299	\$2,392	\$3,235
2007	\$544	\$299	\$2,268	\$3,111
2006	\$544	\$299	\$2,194	\$3,037
2005	\$508	\$200	\$1,823	\$2,531
2004	\$462	\$200	\$1,742	\$2,404
2003	\$403	\$200	\$1,742	\$2,345

Year	Annual Assessment					
	Land	Building	Ttl Taxable	Total Land	Total Bldg	Total Asmt
2020	\$4,800	\$20,000	\$24,800	\$4,800	\$20,000	\$24,800
2019	\$4,800	\$20,000	\$24,800	\$4,800	\$20,000	\$24,800
2018	\$4,800	\$20,000	\$24,800	\$4,800	\$20,000	\$24,800
2017	\$4,800	\$20,000	\$24,800	\$4,800	\$20,000	\$24,800
2016	\$4,800	\$20,000	\$24,800	\$4,800	\$20,000	\$24,800
2015	\$4,800	\$20,000	\$24,800	\$4,800	\$20,000	\$24,800
2014	\$4,800	\$20,000	\$24,800	\$4,800	\$20,000	\$24,800
2013	\$4,800	\$20,000	\$24,800	\$4,800	\$20,000	\$24,800
2012	\$4,800	\$20,000	\$24,800	\$4,800	\$20,000	\$24,800
2011	\$4,800	\$20,000	\$24,800	\$4,800	\$20,000	\$24,800
2010	\$4,800	\$20,000	\$24,800	\$4,800	\$20,000	\$24,800
2009	\$4,800	\$20,000	\$24,800	\$4,800	\$20,000	\$24,800
2008	\$4,800	\$20,000	\$24,800	\$4,800	\$20,000	\$24,800
2007	\$4,800	\$20,000	\$24,800	\$4,800	\$20,000	\$24,800
2006	\$4,800	\$20,000	\$24,800	\$4,800	\$20,000	\$24,800
2005	\$4,800	\$20,000	\$24,800	\$4,800	\$20,000	\$24,800
2004	\$1,200	\$5,000	\$6,200	\$1,200	\$5,000	\$6,200
2003	\$1,200	\$5,000	\$6,200	\$1,200	\$5,000	\$6,200

Sale & Mortgage

Record Date: 02/09/1962 Book: 1640
 Settle Date: 02/09/1962 Page: 98
 Sales Amt: Doc Num:
 Sale Remarks:
 Owner Names: Samuel T & Edith Foster

Mort Rec Date: 03/14/2013 Lender Name: TD BK NA
 Mort Date: 03/02/2013 Term: 10
 Mort Amt: \$36,177 Due Date: 03/06/2023
 Remarks: Conv, Refinance

Mort Rec Date: 07/03/2008 Lender Name: TD BK NA
 Mort Date: 06/05/2008 Term: 0
 Mort Amt: \$46,300 Due Date:
 Remarks: ARM, Conv, Refinance

Record Date: Book: 1613
 Settle Date: 08/29/1961 Page: 410
 Sales Amt: Doc Num:
 Sale Remarks: Blanket Deed

Owner Names: Hartsville Constr CO

Flood Report

Flood Zone in Center of Parcel: X
 Flood Code Desc: Zone X-An Area That Is Determined To Be Outside The 100- And 500-Year Floodplains.
 Flood Zone Panel: 42017C0401J Panel Date: 03/16/2015
 Special Flood Hazard Area (SFHA): Out
 Within 250 feet of multiple flood zone: No

Public Record Only-Property History

Property History

Source	Category	Status	Date	Price	Owner
Public Records		Settle Date	02/09/1962	\$	Samuel T & Edith Foster
Public Records		Settle Date	08/29/1961	\$	Hartsville Constr CO

Maps

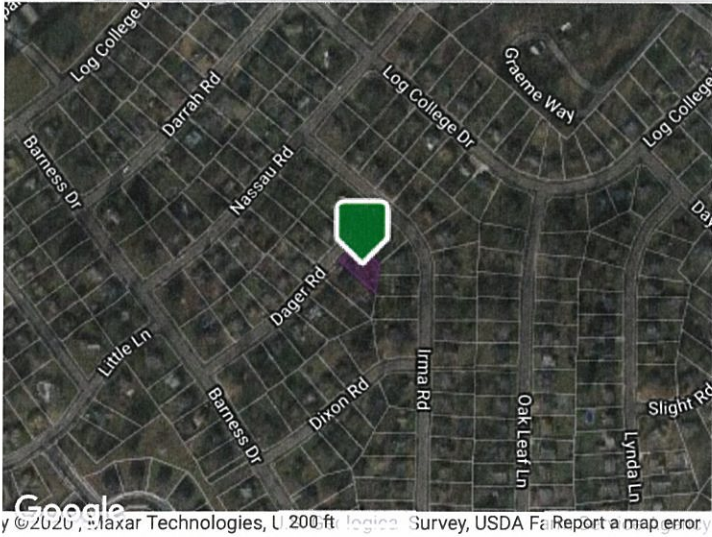

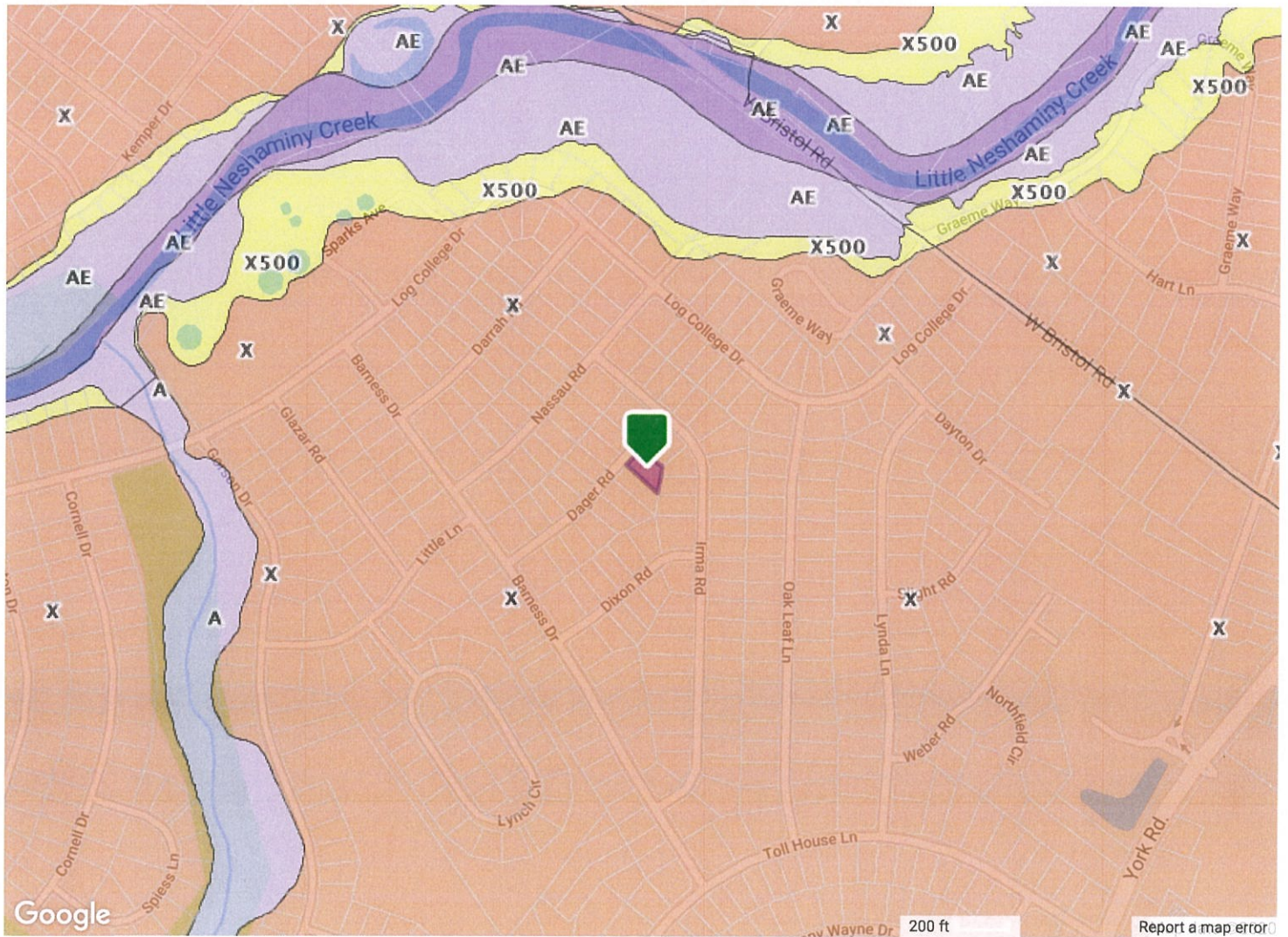

- Coastal 100-Year Floodway
- Coastal 100-year Floodplain
- 100-year Floodway
- 100-year Floodplain
- Undetermined
- 500-year Floodplain incl. levee protected area
- Out of Special Flood Hazard Area

The data on this report is compiled by BRIGHT from various public and private sources. The data on this is not a legal flood determination. Errors may exist in any field on this report, including owner's name, tax amounts, mortgage history, and property characteristics. Verify the accuracy of all data with the county or municipality.

© BRIGHT MLS - All information, regardless of source, should be verified by personal inspection by and/or with the appropriate professional(s). The information is not guaranteed. Measurements are solely for the purpose of marketing, may not be exact, and should not be relied upon for loan, valuation, or other purposes. Copyright 2020. Created: 09/23/2020 10:22 AM

