

York County, Virginia

6203 GEO WASH MEM HWY

General Information

Map #: 024 159
GPIN: R07d-3961-0960
Owner: MULTISERVICES YORKTOWN LLC
Owner Address: 1326 BACK CREEK RD
Owner Address(Cont'd): No Data
Owner City / State / Zip: SEAFORD VA 23696



Site Details

Election Information

Site Details	Election Information
Deeded Lot Size #: .74 Deed Reference: 140013968 Legal Description: PLAT OF EDWIN JOSEPH PT LOT 2 Zoning Code: GB : General Business Government District: GRAFTON Census Tract: 503.06	Supervisor District: 4 Voting Precinct: GRAFTON Polling Place: GRAFTON HIGH SCHOOL House District: 96 Senate District: 3

School District

Elementary School District: GRAFTON BETHEL
High/Middle School District: GRAFTON

Waste Management

Garbage Day: WEDNESDAY
Recycle Day: THURSDAY
Recycle Week: BLUE

Fire and Life Safety Information

Nearest Fire Hydrant(feet): 137
Fire Station Responding: 5751 GEORGE WASHINGTON MEMORIAL HWY, 23692

Assessment Information

	2016 Assessment	2014 Assessment	2012 Assessment	2010 Assessment	2008 Assessment
Land Value:	\$270,000.00	\$270,000.00	\$270,100.00	\$270,100.00	\$216,000.00
Improvement Value:	\$49,800.00	\$73,700.00	\$73,700.00	\$73,700.00	\$81,100.00
Total Value:	\$319,800.00	\$343,700.00	\$343,800.00	\$343,800.00	\$297,100.00

Site Information

Environmental Considerations		Utilities	
Waterfront:	N	Public Water:	Y
Storm Surge Category at Primary Structure Location:	0	Public Sewer:	Y
Flood Zone(s):	X	Well Water:	No Data
Flood Map:	51199C0136D	Septic Tank:	N
Base Flood Elevation:	NONE		
Resource Protection Area:	NO		
Resource Management Area:	NO		
200' Watershed Mgt Prot Area Protection Area:	NO		
500' Watershed Mgt Prot Area Protection Area:	NO		
Aircraft Noise Impact Area:	NO		

Improvements Information

Year Built:	1955	Bedrooms:	0
Primary Building Square Footage*:	1,172	Bathrooms:	0
Stories:	1	Fireplaces:	0
Total Rooms:	5	Central Heat:	Y
		Central Air:	Y
		Fuel Type:	HP-ATA

Construction		Additional Details		Other Details	
Foundation Type:	CRAWL	Building	Size/Quantity	Building Size	Size/Quantity
Roof Type:	COMP SHNG			ASPHALT	2,887
Exterior Type:	ALUMINUM				
Basement:	NONE				

*May or may not reflect gross living area in entirety. Please contact the Real Estate Assessment Division for clarification at (757) 890-3720.

Ownership History

Owner Name	Date of Transfer	Consideration	Deed	Fair Market Sale
MULTISERVICES YORKTOWN LLC	8/29/2014	\$300,000.00	140013968	No Data
WOOD MICHAEL L ETUX	1/1/1983	\$67,500.00	No Data	No Data
JOSEPH EDWIN A	No Data	\$.00	No Data	No Data

York County, Virginia

Legend

- Parcel Boundary
- Plat Link

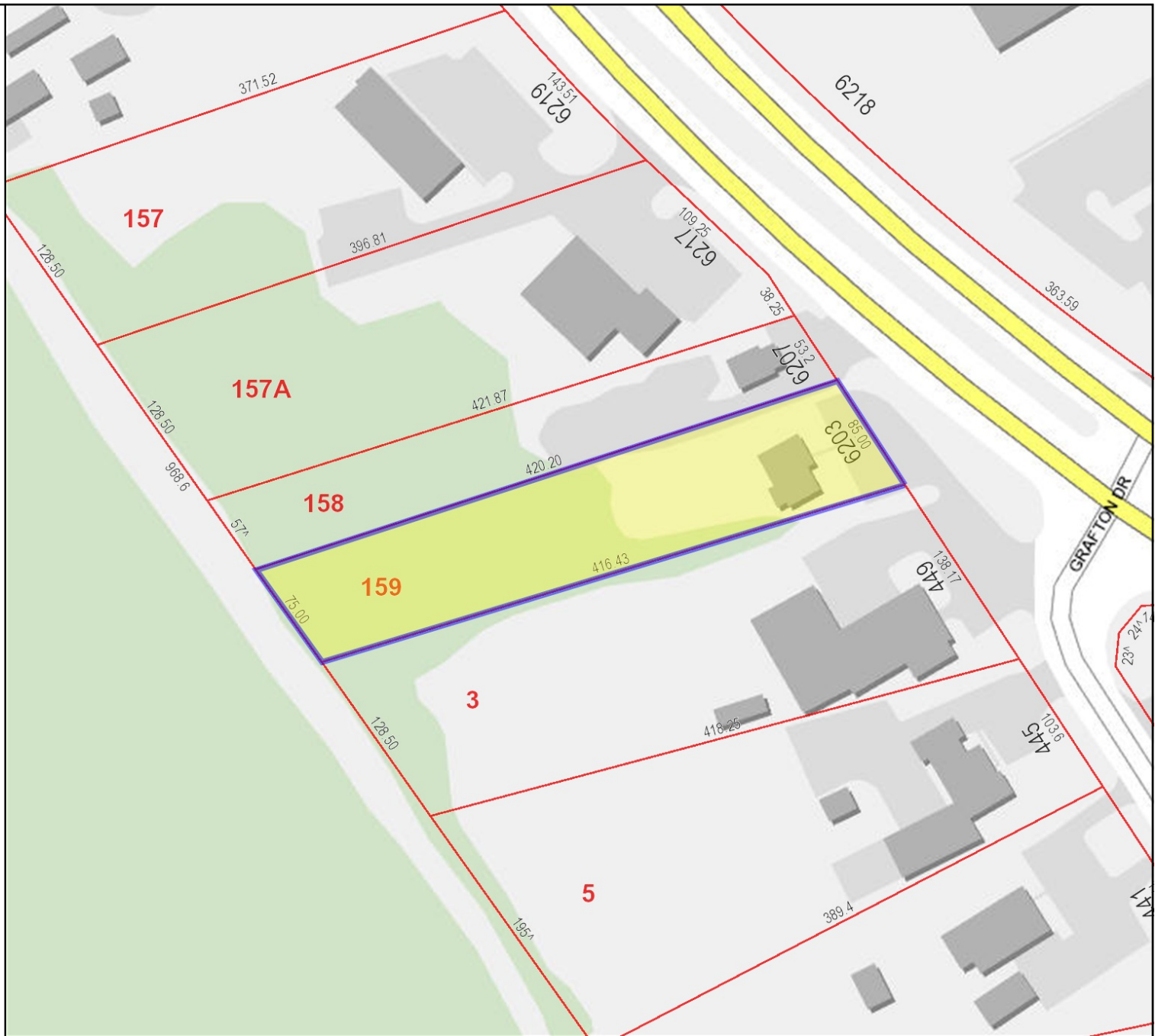

Title: Parcel Boundary

Date: 4/18/2017

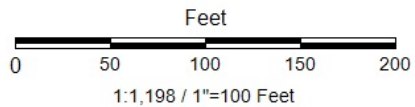

DISCLAIMER: This drawing is neither a legally recorded map nor a survey and is not intended to be used as such. The information displayed is a compilation of records, information, and data obtained from various sources, and York County is not responsible for its accuracy or how current it may be.