

# Christian County, KY PVA

## Summary

**Map Number/Account Number** 253-00 02 068.00 / 337485002  
**Tax District** City of Hopkinsville (01)  
**Description** 2502 FLORENCE ST L2 BLK I WEST SIDE  
 (Note: Not to be used on legal documents)  
**Tax Rates** [See Tax Rates](#)  
**Location Address** 2502 FLORENCE ST  
**Deed Book** 648  
**Deed Page** 588

[View Map](#)



## Owner

[Keeton Gary S & Johnny W Blane](#)  
 809a Country Club Ln  
 Hopkinsville KY 42240

## Value Information

	2023 Certified Tax Roll Assessment
Residential Value	\$55,000
Commercial Value	\$0
Mobile Home Value	\$0
Farm Tax Value	\$0
Farm Fair Cash Value	\$0
TC Build Value	\$0
TC Land Value	\$0
LS Hold Value	\$0
Homestead	No

## Most Recent Sale

Sale Date	Sale Price	Deed Book	Deed Page	Previous Owner
9/1/1999	\$38,000	648	588	K & B RENTALS LLC

## Land Information

Class	RESIDENTIAL	Sidewalks	N
Lot Size	7873	Topography	LEVEL
Frontage	0	Zoning Code	
Depth	0	Subdivision	WEST SIDE ADD BLK
Acreage	0	Unit	
Type	RESIDENTIAL	Block	1
Drive Type	G	Lot	2
Flood Type	N	Land Value	\$0
Utility Type	W		

## Residential Improvement Information

Res Type	SINGLE FMLY	Heat	GAS
Year Built	1965	AC	WINDOW
Foundation	CONCRETE BLOCK	Total Rooms	0
Basement	NONE	Value	\$0
Exterior	VINYL	Living Sqft	783
Bedrooms	2	Basement Sqft	0
Full Bath	1	Garage Sqft	0
Half Bath	0	Porch Sqft	0
Roof Cover	CPSN SHGLS	Patio/Deck Sqft	0
Roof Type	GABLE	Basement Finish	0
Res Cond		Structure	1 STORY
Fireplaces	0	Garage	NONE

## Sale Information

Sale Date ↕	Sale Price ↕	Deed Book ↕	Deed Page ↕	Previous Owner ↕
9/1/1999	\$38,000			MONROE JIM & MICHAEL L BURMAN
1/1/1991	\$26,500			HERBERT D BUCKLEY

## Recent Sales In Area

Sale date range:

From:  To:

## Photos



## Sketches

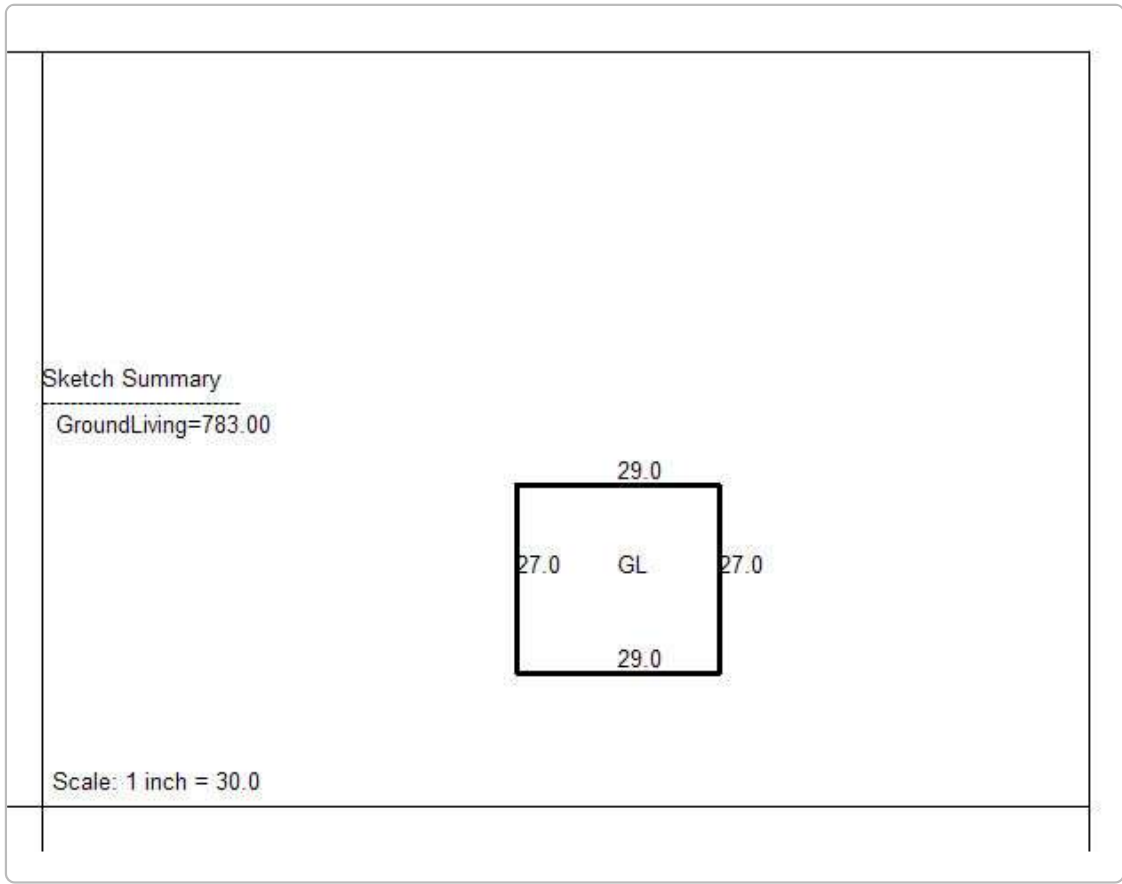

No data available for the following modules: Mobile Home Information, Commercial Information.

The Christian County Assessor's Office makes every effort to produce the most accurate information possible.  
No warranties, expressed or implied, are provided for the data herein, its use or interpretation.  
[User Privacy Policy](#) | [GDPR Privacy Notice](#)  
[Last Data Upload: 9/19/2023, 4:53:34 PM](#)

[Contact Us](#)

Developed by  
 **Schneider**  
GEOSPATIAL