

Christian County, KY PVA

Summary

Map Number/Account Number 253-00 02 069.00 / 337485001
Tax District City of Hopkinsville (01)
Description 2500 FLORENCE ST L1 BLK I WEST SIDE
 (Note: Not to be used on legal documents)
Tax Rates [See Tax Rates](#)
Location Address 2500 FLORENCE ST
Deed Book 648
Deed Page 588

[View Map](#)



Owner

[Keeton Gary S & Johnny W Blane](#)
 809a Country Club Ln
 Hopkinsville KY 42240

Value Information

| | 2023 Certified Tax Roll Assessment |
|----------------------|------------------------------------|
| Residential Value | \$60,000 |
| Commercial Value | \$0 |
| Mobile Home Value | \$0 |
| Farm Tax Value | \$0 |
| Farm Fair Cash Value | \$0 |
| TC Build Value | \$0 |
| TC Land Value | \$0 |
| LS Hold Value | \$0 |
| Homestead | No |

Most Recent Sale

| Sale Date | Sale Price | Deed Book | Deed Page | Previous Owner |
|-----------|------------|-----------|-----------|-------------------|
| 9/1/1999 | \$38,000 | 648 | 588 | K & B RENTALS LLC |

Land Information

| | | | |
|--------------|-------------|-------------|-------------------|
| Class | RESIDENTIAL | Sidewalks | N |
| Lot Size | 0 | Topography | LEVEL |
| Frontage | 0 | Zoning Code | |
| Depth | 0 | Subdivision | WEST SIDE ADD BLK |
| Acreage | 0 | Unit | |
| Type | RESIDENTIAL | Block | I |
| Drive Type | G | Lot | 1 |
| Flood Type | N | Land Value | \$0 |
| Utility Type | W | | |

Residential Improvement Information

| | | | |
|------------|----------------|-----------------|---------|
| Res Type | SINGLE FMLY | Heat | GAS |
| Year Built | 1965 | AC | CENTRAL |
| Foundation | CONCRETE BLOCK | Total Rooms | 0 |
| Basement | NONE | Value | \$0 |
| Exterior | VINYL | Living Sqft | 894 |
| Bedrooms | 2 | Basement Sqft | 0 |
| Full Bath | 1 | Garage Sqft | 0 |
| Half Bath | 0 | Porch Sqft | 0 |
| Roof Cover | CPSN SHGLS | Patio/Deck Sqft | 0 |
| Roof Type | GABLE | Basement Finish | 0 |
| Res Cond | | Structure | 1 STORY |
| Fireplaces | 0 | Garage | NONE |

Sale Information

| Sale Date ↕ | Sale Price ↕ | Deed Book ↕ | Deed Page ↕ | Previous Owner ↕ |
|-------------|--------------|-------------|-------------|-------------------------------|
| 9/1/1999 | \$38,000 | | | MONROE JIM & MICHAEL L BURMAN |
| 1/1/1991 | \$26,000 | | | HERBERT D BUCKLEY |

Recent Sales In Area

Sale date range:

From: To:

Photos



Sketches

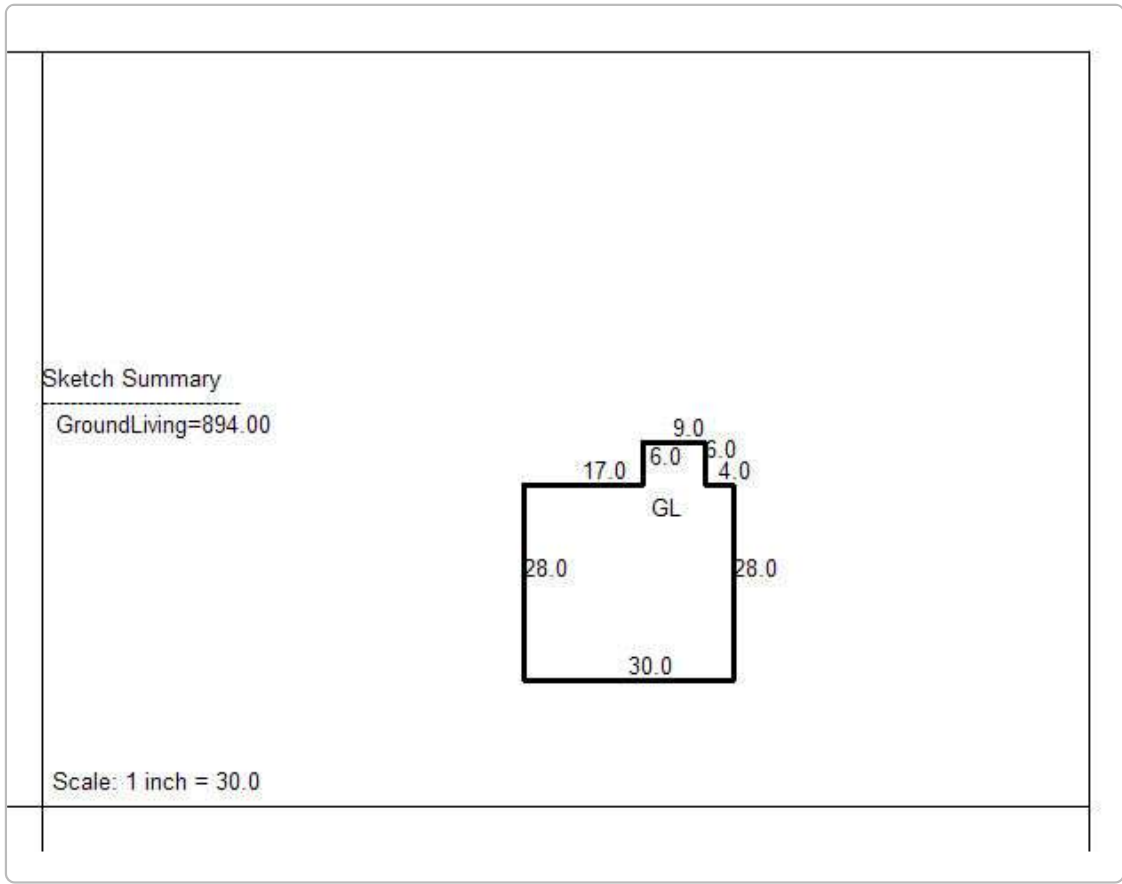

No data available for the following modules: Mobile Home Information, Commercial Information.

The Christian County Assessor's Office makes every effort to produce the most accurate information possible.
No warranties, expressed or implied, are provided for the data herein, its use or interpretation.
[User Privacy Policy](#) | [GDPR Privacy Notice](#)
[Last Data Upload: 9/19/2023, 4:53:34 PM](#)

[Contact Us](#)

