

Christian County, KY PVA

Summary

Map Number/Account Number 136-0000 079.00 / 234300001
Tax District County (00)
Description 5975 GREENVILLE RD
(Note: Not to be used on legal documents)
Tax Rates [See Tax Rates](#)
Location Address 5975 GREENVILLE RD
Deed Book 587
Deed Page 249

[View Map](#)



Owner

Goode Carolyn
 5975 Greenville Rd
 Hopkinsville KY 42240

Value Information

	2023 Certified Tax Roll Assessment
Residential Value	\$0
Commercial Value	\$0
Mobile Home Value	\$0
Farm Tax Value	\$184,331
Farm Fair Cash Value	\$320,052
TC Build Value	\$0
TC Land Value	\$0
LS Hold Value	\$0
Homestead	Yes

Most Recent Sale

Sale Date	Sale Price	Deed Book	Deed Page	Previous Owner
6/1/2002	\$92,000	587	249	GOODE JAMES E

Land Information

Class	FARM	Sidewalks	N
Lot Size	0	Topography	
Frontage	0	Zoning Code	
Depth	0	Subdivision	
Acreage	37.763	Unit	
Type	FARM	Block	
Drive Type	G	Lot	
Flood Type		Land Value	\$151,052
Utility Type			

Residential Improvement Information

Res Type	SINGLE FMLY	Heat	ELECTRIC
Year Built	2005	AC	CENTRAL
Foundation	BRICK ON BLOCK	Total Rooms	0
Basement	NONE	Value	\$150,000
Exterior	VINYL	Living Sqft	1620
Bedrooms	2	Basement Sqft	0
Full Bath	2	Garage Sqft	750
Half Bath	0	Porch Sqft	0
Roof Cover	CPSN SHGLS	Patio/Deck Sqft	0
Roof Type	GABLE	Basement Finish	0
Res Cond		Structure	1 STORY
Fireplaces	0	Garage	ATTCHD 1 CAR

Res Type	COTTAGE
Year Built	0
Foundation	WOOD
Basement	
Exterior	FRAME
Bedrooms	0
Full Bath	0
Half Bath	0
Roof Cover	METAL
Roof Type	GABLE
Res Cond	
Fireplaces	0

Heat	
AC	
Total Rooms	0
Value	\$1,500
Living Sqft	345
Basement Sqft	0
Garage Sqft	0
Porch Sqft	0
Patio/Deck Sqft	0
Basement Finish	0
Structure	1 STORY
Garage	

Sale Information

Sale Date	Sale Price	Deed Book	Deed Page	Previous Owner
6/1/2002	\$92,000			ERKILETIAN MAXINE B
6/1/1999	\$48,100			DR D H ERKILETIAN

Recent Sales In Area

Sale date range:

From: To:

Photos



Sketches

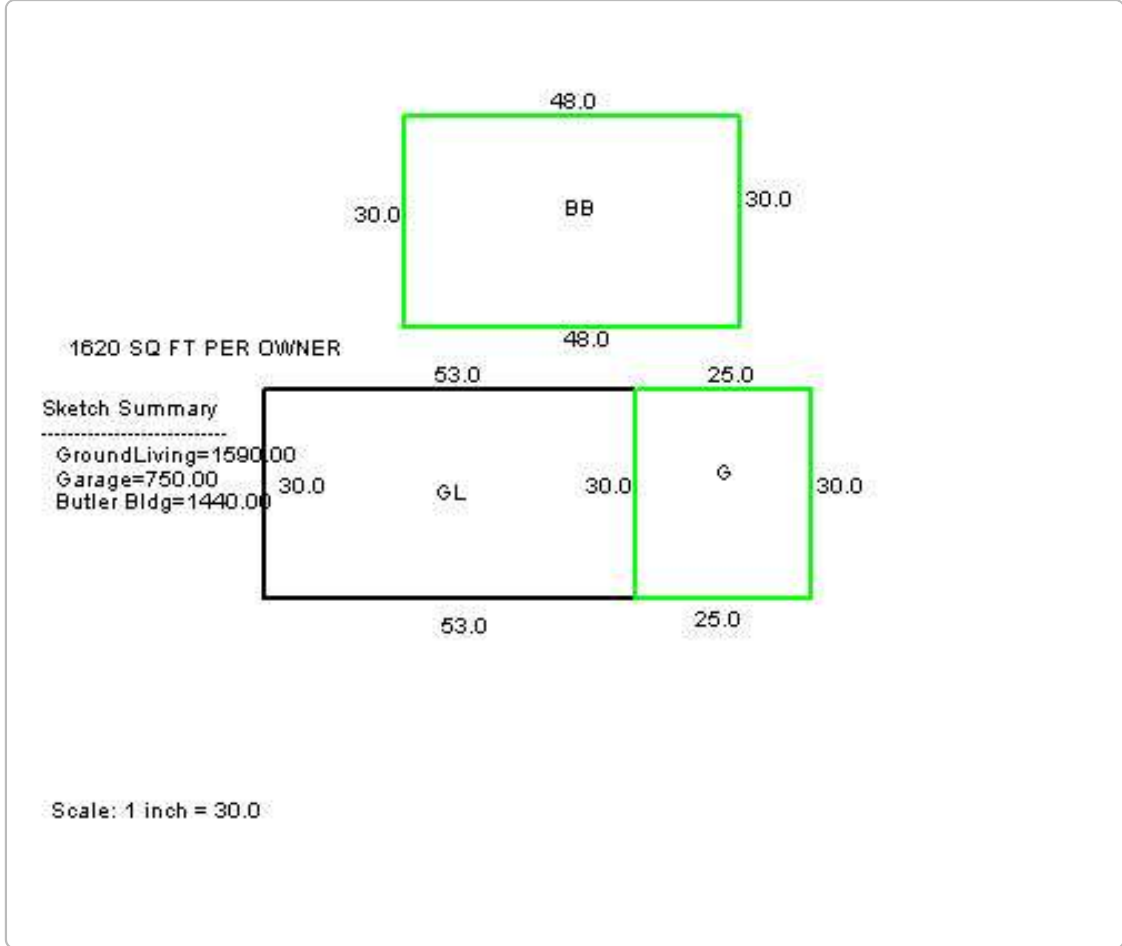

No data available for the following modules: Mobile Home Information, Commercial Information.

The Christian County Assessor's Office makes every effort to produce the most accurate information possible. No warranties, expressed or implied, are provided for the data herein, its use or interpretation.
[User Privacy Policy](#) | [GDPR Privacy Notice](#)
 Last Data Upload: 9/19/2023, 4:53:34 PM

[Contact Us](#)

Developed by
 Schneider
 GEOSPATIAL