

South Amherst, Ohio



McConnell

(6) Challenger Track
Scraper Tractors

Scraper Pans

Trucks & Trailers

Excavators, Payloader
Backhoe, Telehandlers

Concrete Equipment

Ag Tractors & Tillage



AUCTION

**SURPLUS
EQUIPMENT**



614.626.SOLD

www.thewendtgroup.com

MONDAY, SEPTEMBER 20TH • 10:30AM

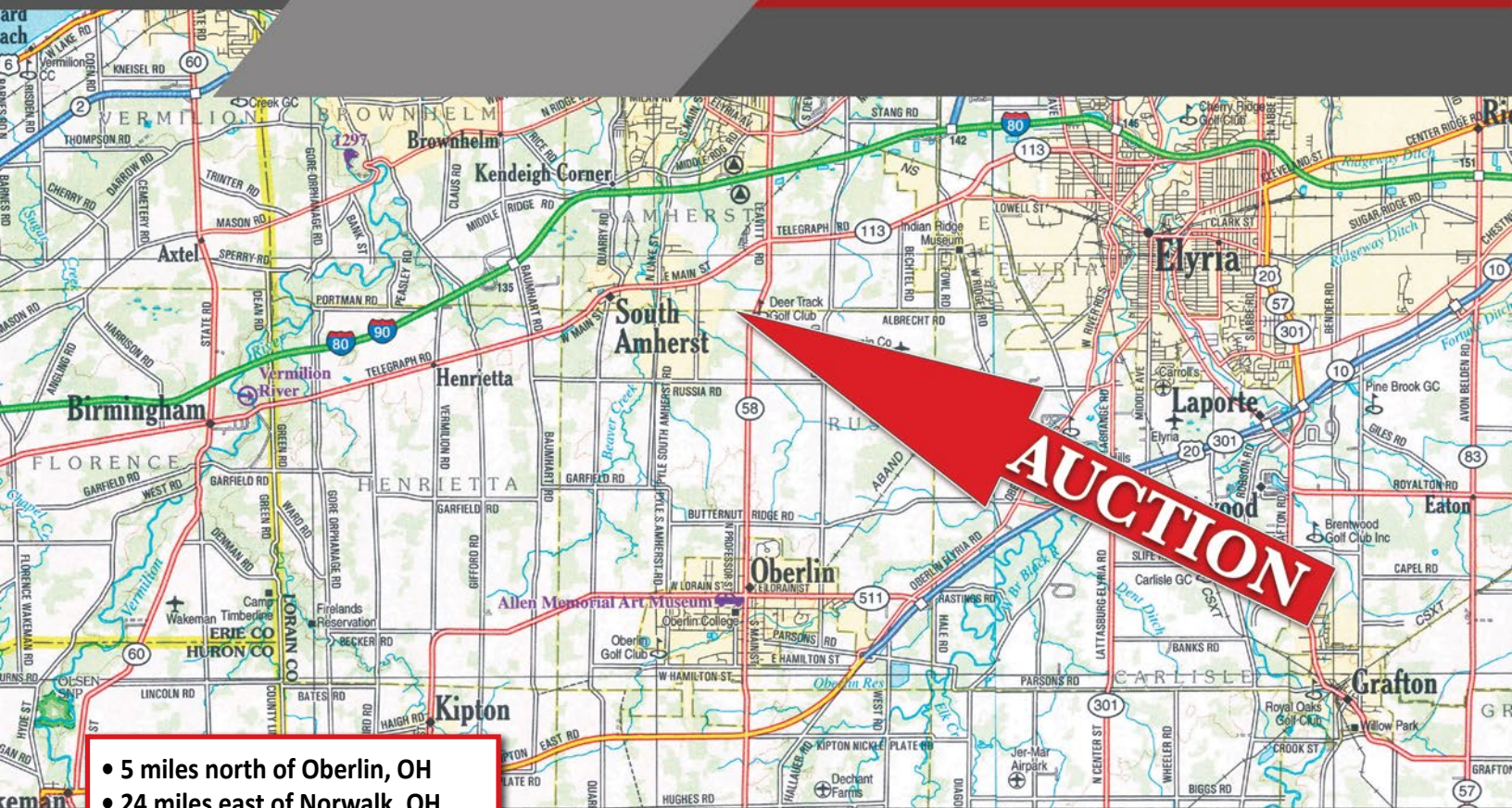

AUCTION

- 5 miles north of Oberlin, OH
- 24 miles east of Norwalk, OH
- 35 miles west of Cleveland, OH
- 52 miles north of Mansfield, OH

AUCTION LOCATION: The Lorain Co. Raceway Park, 9100 Leavitt Road (St. Rte. 58), S. Amherst, OH 44001

AUCTION DIRECTIONS: From I-80 (toll road) and Leavitt Rd./St. Rte. 58 – Take Leavitt Rd./ St. Rte. 58 south 2 miles to The Lorain Co. Raceway Park. From Oberlin, Ohio – Take Leavitt Rd./St. Rte. 58 north 5 miles to The Lorain Co. Raceway Park.

INSPECTION DATES:
 (at The Lorain Co. Raceway Park)
 Friday, September 17th, 2021 at 9am – 5pm
 Saturday, September 18th, 2021 at 9am – 2pm



BID ONLINE WITH **BidSpotter.com**
 For Online Bidding Questions,
 Call: Nathan Whitney 740-505-0482

McConnell

Lorain Co. Raceway - South Amherst, Ohio

MONDAY, SEPTEMBER 20TH • 10:30AM

AUCTION

SURPLUS EQUIPMENT

THE WENDT GROUP

Land & Agricultural Asset Auctions

AUCTIONEER'S NOTE: McConnell Excavating and McConnell Farms have decided to update their current line of equipment for their construction and agricultural business. All equipment has been properly maintained by McConnell's experienced in-house mechanics with current service/maintenance records. We invite you to be a part of this great opportunity to add surplus equipment to enhance your own operation. McConnell Excavating & McConnell Farms look forward to seeing you on auction day!



CONSTRUCTION EQUIPMENT

SCRAPER TRACTORS

- Challenger MT875B track scraper tractor, CAT C-18 engine, 588 hp, 16 spd powershift, NEW 36" belts, E-Ject scraper bogies, front weights, front pull cable, idler weights, E-Ject scraper hitch w/ roller belt guards, 4 hyd remotes w/ flat face threaded couplers, 1 hyd remote with Pioneer couplers, auto climate controls, 10,265 hrs, SN AGC-MT875TBFT60166
- Challenger MT875B track scraper tractor, CAT C-18 engine, 588 hp, 16 spd powershift, 36" belts, E-Ject scraper bogies, front weights, front pull cable, idler weights, E-Ject scraper hitch w/ roller belt guards, 4 hyd remotes w/ flat face threaded couplers, 1 hyd remote with Pioneer couplers, auto climate controls, 9487 hrs, SN AGCMT875HBF60190
- Challenger MT865B track scraper tractor, CAT C-18 engine, 525 hp, 16 spd powershift, 36" belts, E-Ject scraper bogies, front weights, front pull cable, idler weights, E-Ject scraper hitch w/ roller belt guards, 4 hyd remotes w/ flat face threaded couplers, 2 hyd remotes with Pioneer couplers, auto climate controls, 10,604 hrs, SN AGCMT-865VBDS61023

- Challenger MT865B track scraper tractor, CAT C-18 engine, 525 hp, 16 spd powershift, 36" belts, E-Ject scraper bogies, front weights, front pull cable, idler weights, E-Ject scraper hitch w/ roller belt guards, 4 hyd remotes w/ flat face threaded couplers, 2 hyd remotes with Pioneer couplers, auto climate controls, 10,607 hrs, SN AGC-MT865HBDS61043
- Challenger MT865B track scraper tractor, CAT C-18 engine, 525 hp, 16 spd powershift, 30" belts, front weights, front pull cable, idler weights, E-Ject scraper hitch w/ roller belt guards, 4 hyd remotes w/ flat face threaded couplers, 2 hyd remotes with Pioneer couplers, auto climate controls, 10,140 hrs, SN AGCMT865LBDS61042
- Challenger MT865B track scraper tractor, CAT C-16 engine, 512 hp, 16 spd powershift, 30" belts, front weights, front pull cable, idler weights, E-Ject scraper hitch w/ roller belt guards, 4 hyd remotes w/ flat face threaded couplers, 2 hyd remotes with Pioneer couplers, auto climate controls, 11,399 hrs, SN AGCMT865HBDS0947

**SEE OUR WEBSITE FOR FULL LISTING,
PHOTOS, & INFORMATION**



SCRAPER PANS

- John Deere 1810 pull type ejector scraper, (4) 20.5R25 tires, front pan
- John Deere 1810 pull type ejector scraper, (4) 20.5-25 tires, rear pan
- (7) K-Tech 1228 ejector scrapers, (4) 23.5R25 tires, SN – KS 2193, KS 2194, KS 2195, KS 2196, KS 2197, KS 2198, KS 2199





TRUCKS AND TRAILERS

- 2003 Kenworth W900 semi truck, 72" sleeper, Cummins N-14 red top, 13 spd Eaton, shows 254,079 miles, cruise, 262" WB, 275/80R24.5 tires, ¼ fenders, PTO, 2 line wet kit, air slide 5th wheel, twin screw, air ride, alum headace rack, VIN 1XK-WD69X13J391731
- 2005 Peterbilt 379 semi truck, 68" sleeper, 3406E CAT 475 hp, 13 speed Eaton, air ride, twin screw, air slide 5th wheel, 24.5 tires, alum wheels, 272" WB, VIN 1XP-5DB9X-5-5D826055
- 2000 Volvo / Autocar truck, 6x6, Cummins ISM, Allison HT-740D automatic trans, twin screw, diff lock, 445/65R22.5 single drive and steer tires, 3 air lift steerable axles w/11R22.5 tires, 18' slinger belt bed, VIN 4V5SG2UFOYN520762
- 2001 50 ton Eager Beaver hyd detach trailer, 121,000 GVWR, 24' well, tri axle, air ride, 255/70R22.5 tires, alum rims, VIN 112SD24812L059667
- 2003 35 ton Eager Beaver hyd detach trailer, 27' well, tandem axle, air ride, 255/70R22.5 tires, alum rims, VIN 112SC24273L060668
- (2) 2010 28' East alum dump trailers, alum frame, tandem axle, spring ride, alum wheels, 11R22.5 tires, alum rims, electric tarps, VIN 1E1D-2M286ARB44774, VIN 1E1D2M284ARB44770
- 2015 22' PJ tilt deck trailer, 96" wide, pintle hitch, tandem axle, electric brakes, VIN 4P5T82222F3011224

HYDRAULIC EXCAVATORS

- John Deere 350G LC excavator, 32" steel pads, C/H/A, JRB hyd coupler, aux boom hyd, 4624 hrs, SN 1FF350GXPEE810011
- Hitachi ZX 245 USLC-5N excavator, 32" steel pads, C/H/A, 42" rock bucket, hyd coupler, aux boom hyd, 3761 hrs, SN HCMDCP60P00400278
- Hitachi ZX 200 LC-3 excavator, 32" steel pads, C/H/A, 58" smooth bucket, hyd coupler, aux boom hyd, 6995 hrs, SN FF00AST320285
- Hitachi 200LC excavator, 32" steel pads, C/H/A, JRB hyd coupler, 52" rock bucket, hyd thumb, aux boom hyd, 8524 hrs, SN 1FFASTOXVBD321028

- Hitachi ZX 160 LC-3 excavator, 28" steel pads, C/H/A, 35" rock bucket, hyd coupler, aux boom hyd, 9X68 hrs, SN FF01T1Q010177
- John Deere 135D excavator, 20" rubber pads, C/H/A, 8' hyd blade, JRB hyd coupler, 4' smooth bucket, aux boom hyd, 6309 hrs, SN 1FF135DXP-CD303093
- John Deere 75C excavator, 18" rubber pads, C/H/A, 8' blade, 36" smooth bucket, manual coupler, hyd thumb, aux boom hyd, 5950 hrs, SN FF-075CX013062

PAYLOADER, BACKHOE, TELEHANDLERS, ROLLERS

- Case 621B payloader, C/H/A, 20.5-25 tires, 102" bucket, hyd quick attach, self-leveling, shows 212 hrs, SN JEE0042867
- John Deere 410J backhoe, C/H/A, 4x4, 21L-24 rear, 12.5/80R18 front, 7 ½' front bucket, hyd coupler, 24" digging bucket, 3883 hrs, SN 1TO-410JXE0188412
- (5) JLG G9-43A telehandlers, 4x4, diesel, all wheel steer, 13.00-24 tires, diesel, cab, 6,000-7,500 hrs
- Bomag BW 211 D-3 vibratory roller, 23.1-26 tires, open ROPS, 5,967 hrs.

CONCRETE EQUIPMENT

- Somero S240 laser screed, 13' screed, 38x20.00-16.1 tires, 8365 hrs, SN 89511962, sells with complete Trimble 3D laser system

MISC CONSTRUCTION EQUIPMENT

- (8) Magnum MTL 3060 light plants, Diesel engines, 6 KW gen, 4 lights, single axle trailers
- 16' Holmes Rollerblade 16F blade, pull type, hyd lift
- 16' Holmes Rollerblade 16E blade, pull type, hyd lift





AGRICULTURE EQUIPMENT

AG TRACTORS

- Case IH 540 QuadTrac tractor, powershift, 30" belts, 6 hyd remotes, 1000 PTO, ag drawbar, pull cable, Pro 700 monitor, 2014 hrs, SN ZFF308171
- John Deere 8370R tractor, MFWD, Michelin Mach X Bib 620/70R46 rear duals, 600/70R30 front, IVT, ILS, front weights, rear wheel weights, 5 hyd remotes, 3pt, quick hitch, 1000 PTO, 10" gen 4 armrest screen, AutoTrac, LED lights, 5197 hrs, SN 1RW8370RVGD111131
- John Deere 8370R tractor, MFWD, Michelin Mach X Bib 620/70R46 rear duals, 600/70R30 front, IVT, ILS, front weights, rear wheel weights, 5 hyd remotes, 3pt, quick hitch, 1000 PTO, 10" gen 4 armrest screen, AutoTrac, LED lights, 5452 hrs, SN 1RW8370REGD111216
- John Deere 8370R tractor, MFWD, Michelin Mach X Bib 620/70R46 rear duals, 600/70R30 front, IVT, ILS, front fenders, front weights, rear wheel weights, 4 hyd remotes, 3pt, quick hitch, 1000 PTO, 10" gen 4 armrest screen, AutoTrac, Section Control, 6307 hrs, SN 1RW8370RTGD112210
- John Deere 8345R tractor, MFWD, 620/70R46 rear duals, 600/70R30 front, IVT, ILS, front weights, rear wheel weights, 4 hyd remotes, 3pt, quick hitch, 1000 PTO, 10" gen 4 armrest screen, AutoTrac, 7523 hrs, SN 1RW8345RJGS111050
- Case IH 7250 tractor, MFWD, C/H/A, 480/80R46 rear duals, 420/90R30 front, 18F 4R powershift, front weights, 3 hyd remotes, 3pt, 1000 PTO, shows 2047 hrs, SN JJA0057822
- Case IH 7150 tractor, MFWD, C/H/A, 18.4R46 rear duals, 16.9R30 front, 18F 4R powershift, front weights, rear wheel weights, 4 hyd remotes, 3pt, 1000 PTO, shows 2218 hrs, SN JJA0043473
- Case IH 7140 tractor, MFWD, C/H/A, 480/80R46 rear duals, 420/90R30 front, 18F 4R powershift, front weights, 3 hyd remotes, 3pt, 1000 PTO, 7493 hrs, SN JJA0031002

TILLAGE

- Case IH Eco-Tiger 875 11 shank ripper, hyd fold, walking tandems, front discs, wing points with shank guards, rear leveling disc, rear basket, SN YFD080686

- Case IH Eco-Tiger 875 9 shank ripper, hyd fold, 445/65R22.5 tires, front discs, wing points with shank guards, rear leveling disc, rear basket, SN YKD087509
- Kuhn 4830 9 shank deep ripper, hyd fold, pull type, depth wheels, tandem transport tires, SN KK-SA1023V40C00041
- (2) 30' Kuhn Krause 8005 Exclerator vertical till, hyd fold, hyd angle, hyd down pressure spider wheels, roundbar basket, rear hitch and hyd, lights, walking tandems, SN 8005-30-A0765, SN 8005-30-B0192
- (2) 30' Landoll Brillion WFP30 packers, hyd fold, tandem transport tires, lights, ext. hitch, notched wheels, SN PXD1602965, SN PXC1803381
- 36' Landoll Brillion WFPDS36 packer, hyd fold, ext. hitch, tandem tires, SN PXD1100153
- 33' Sunflower 1436 disc, hyd fold, hyd fore/aft, rock flex, 9" spacing, rear hitch w/hyd, walking tandem, rear basket, wing wheels, SN AGC-S14360EZ100003-33
- 36' Kuhn Krause Landsman 6205 soil finisher, hyd double fold, front Excalibur blades, 3 bar spike-tooth drag, rolling basket, rear hitch w/ hyd, walking tandems, hyd depth on front blades, SN 6205-36-B0259

MANURE APPLICATOR & GRAIN CART

- Meyer Crop Max 9530 spreader, S-100 spinner, 1000 PTO spinner drive, hyd drive floor chain, scales, side ext, poly floor, box SN 2095228, Meyer XTSSW 4500T track undercarriage, Camso 100-3613 tracks w/ 36" belts, oil bath hubs, AgLeader screen with VRA
- Killbros 1613 grain cart, dual auger, 48" Equalizer tracks, 5-point scale, Autolube, 1000 PTO, electric roll tarp, hyd spout, SN B39870115
- Wagner IND.41 chain conveyor, 41" x 40', with self-contained diesel power unit, truck unload, pull type, w/hyd drive and hyd raise, SN HP0126-19

GPS EQUIPMENT

- John Deere StarFire 6000 receiver, SF1, SN PCS161B353193
- John Deere StarFire 6000 receiver, SF1, SN PCS161B354450
- John Deere StarFire 6000 receiver, SF1, SN PCS161B354046
- John Deere StarFire 6000 receiver, SF1, SN PCS161B209094
- Case IH 372 receiver, RTK, Sierra Wireless modem



BID
ONLINE
WITH



For Online Bidding Questions,
Call: Nathan Whitney 740-505-0482

TERMS: Cash or Check w/ photo ID. Credit Card accepted w/4% Convenience fee. All items sold "AS IS". Bring your trailer, loading available auction day.

OWNER: McConnell Excavating & McConnell Farms, Eric McConnell
FOR EQUIPMENT QUESTIONS: Call Auction Manager – Nick Cummings, CAI/Auction Advisor 740-572-0756



614.626.SOLD

www.thewendtgroup.com

INSPECTION DATES:

(at The Lorain Co. Raceway Park)

Fri, Sept. 17th • 9am-5pm

Sat, Sept. 18th • 9am-2pm



McConnell

SURPLUS EQUIPMENT

AUCTION

MON, SEPT. 20TH, 2021 • 10:30AM

121 Jackson Street, Plain City, OH 43064

Kevin Wendt, CAI - President / Auctioneer / Broker
419.566.1599 | kevin@thewendtgroup.com

Dale Evans - General Manager / Auctioneer
260.894.0458 | dale@thewendtgroup.com

Nick Cummings, CAI - Auctioneer / Auction Advisor
740.572.0756 | nick@thewendtgroup.com

**GET AUCTION
INFO BY TEXT!**
TEXT AUCTION
TO 614-636-4191



614.626.SOLD

www.thewendtgroup.com

McConnell

South Amherst, Ohio



AUCTION

SURPLUS EQUIPMENT



614.626.SOLD

www.thewendtgroup.com



MONDAY, SEPTEMBER 20TH • 10:30AM